

# HALF HP EVOLUTION SERIES FOUNTAINS

## INSTALLATION

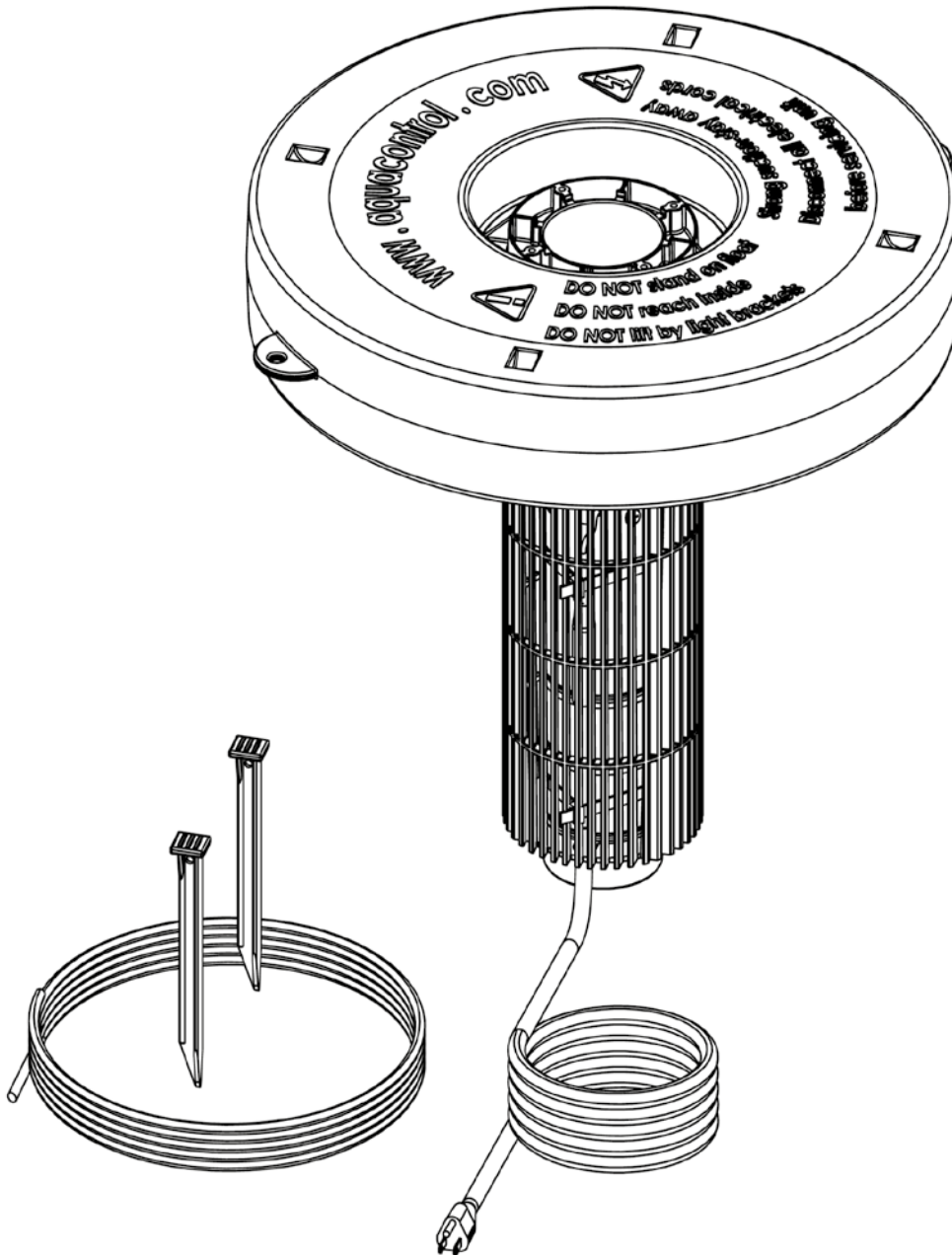

AERATION  
FOUNTAINS  
AUSTRALIA



HALF HP FOUNTAIN



AERATION FOUNTAINS  
AUSTRALIA

Head Office: 41 Yazaki Way, Carrum Downs, Vic. Australia 3201 | Phone: 03 9071 2442

For more information visit [www.FOUNTAINSAUSTRALIA.com.au](http://www.FOUNTAINSAUSTRALIA.com.au)

# SAFETY INSTRUCTIONS

**IMPORTANT:** Reading and understanding these instructions and warranty disclaimer are necessary prior to product installation and operation.

- Under NO circumstances should anyone enter the water with the electrical equipment plugged in.
- NEVER run the unit out of the water. It may damage the motor seals.
- NEVER lift or drag the fountain by the power or light cord.
- Suitable for FRESHWATER applications only.
- The fountain suction screen should be inspected for clogging on a monthly basis. If matted weeds, leaves or plastic bags are present, remove them with a bristle brush. Failure to keep the suction screen clear of blockages will cause low water flow and may cause premature motor failure. This type of failure is NOT covered under the Aqua Control, Inc. Manufacturer’s Warranty.
- Aqua Control, Inc. or its distributors are not liable for electrician’s fees incurred for troubleshooting electrical issues.

## TABLE OF CONTENTS

<b>Assembling Your Floating Evolution Fountain.....</b>	<b>3</b>	<b>Proper Cable Positioning.....</b>	<b>9</b>
<b>Mooring Lines &amp; Plugs.....</b>	<b>5</b>	<b>To Avoid Fountain From Tipping.....</b>	<b>11</b>
<b>Light Installation.....</b>	<b>6</b>	<b>How to Stake.....</b>	<b>13</b>
<b>Evolution Parts List.....</b>	<b>7</b>	<b>Troubleshooting Guide.....</b>	<b>14</b>
<b>Choosing an ideal fountain location.....</b>	<b>8</b>		

### Parts Included

- 1/2 HP Fountain (with Tornado and Torrent Spray Pattern capabilities)
- Motor Cord or Quick Disconnect
- Control Box
- Mooring Rope
- Mooring Stakes

### Optional Accessories

- Lighting Kits

# 1. Assembling Your Floating Evolution

## Step #1

Place motor cord and fountain pump through the centre of float. Align notch on fountain pump with slot in float. Float should be positioned print side up.

## Step #2

Measure and cut the mooring rope into two lengths. Tie tabs on float. Connect fountain plug to power cord. Refer to page 5 for detailed instructions.

## Step #3

Tie mooring (rope) lines to mooring stakes. (See page 5 for detailed instructions).

If an optional light set was purchased see page 6 for lighting instructions before putting the unit in the water.

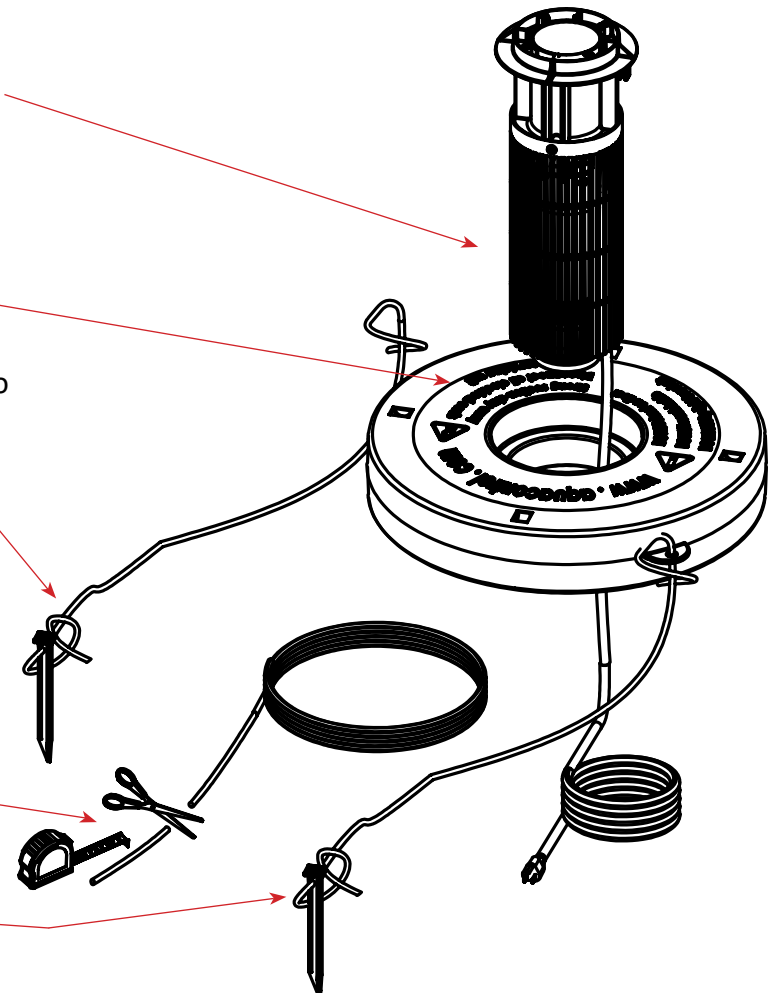

Mooring tabs

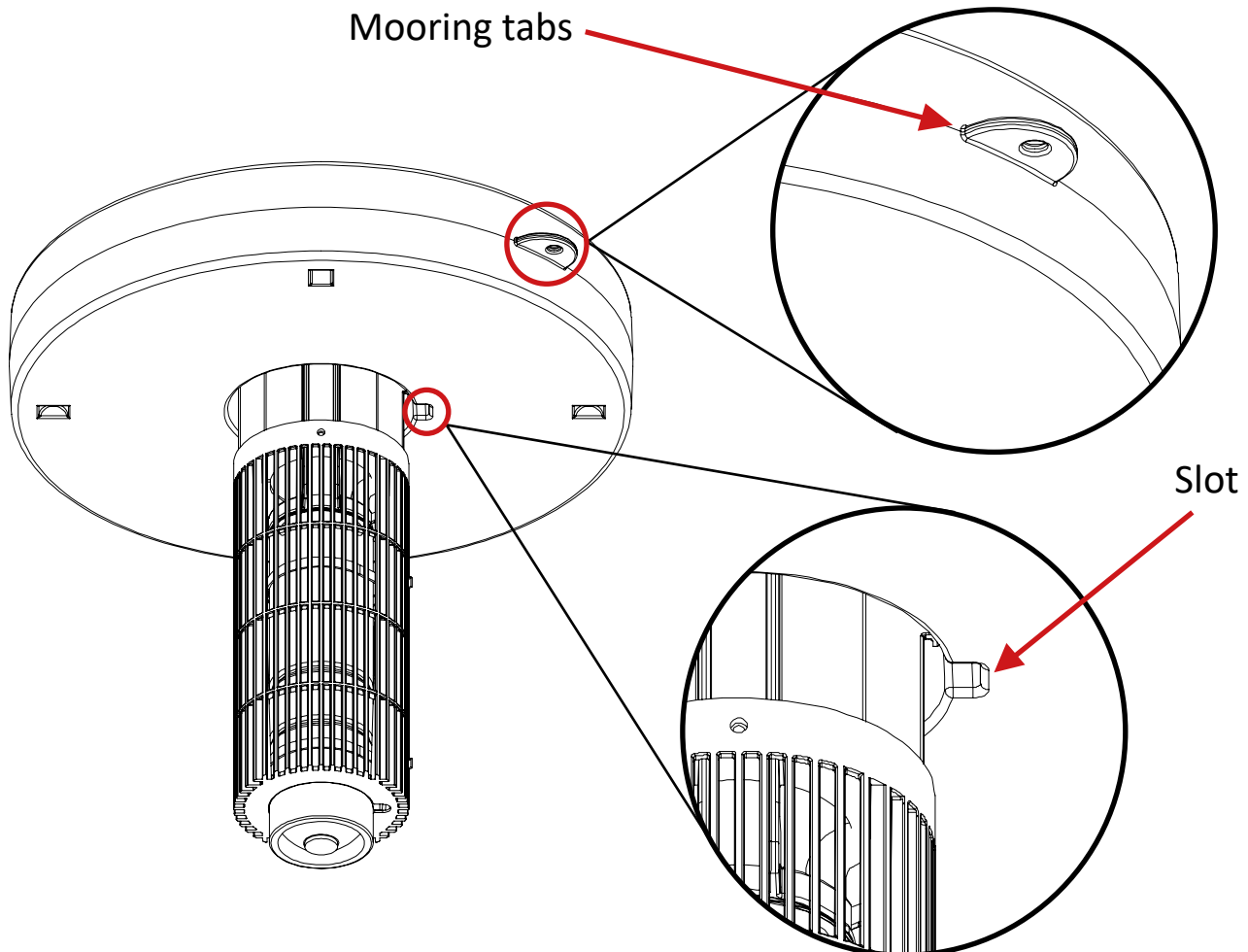

Slot

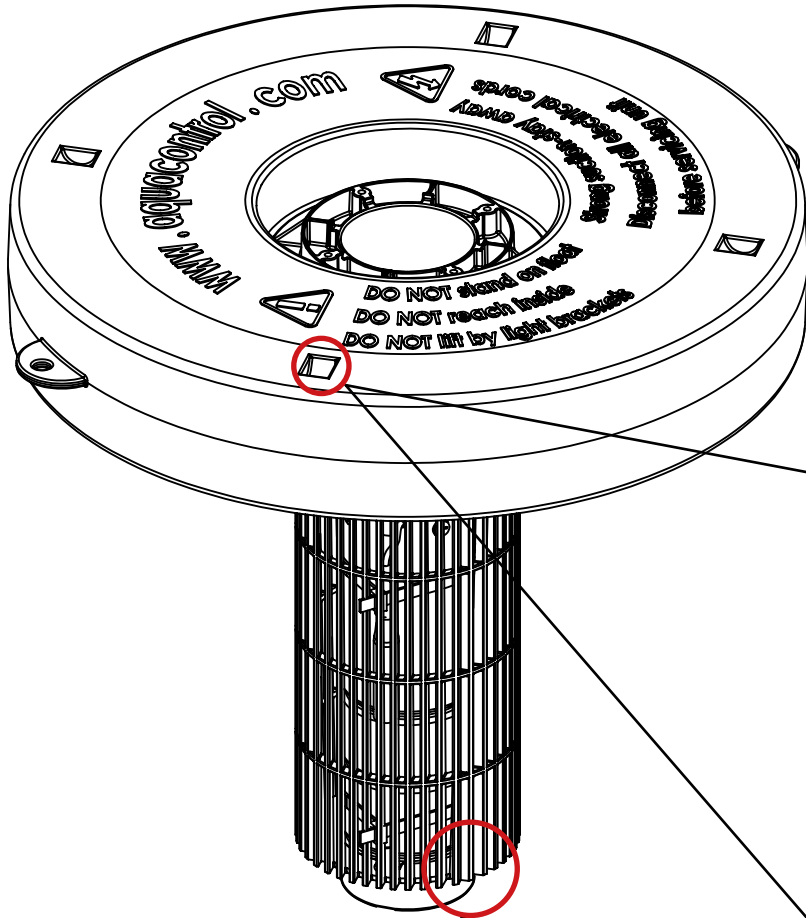

These holes are the mounting points for the optional LED lights. Leave alone if not using lights with your fountain.

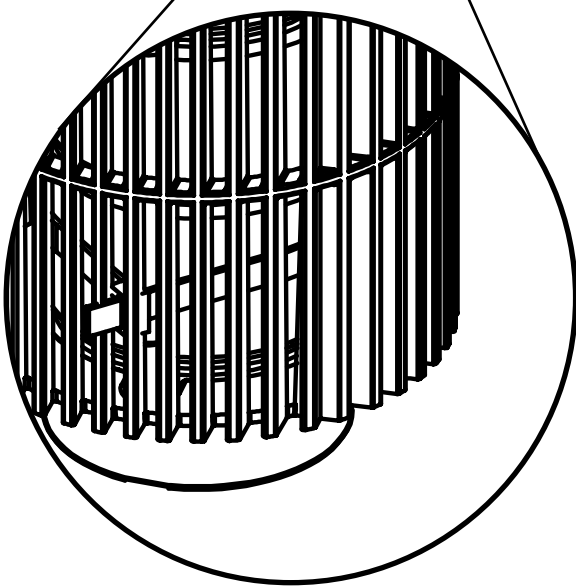
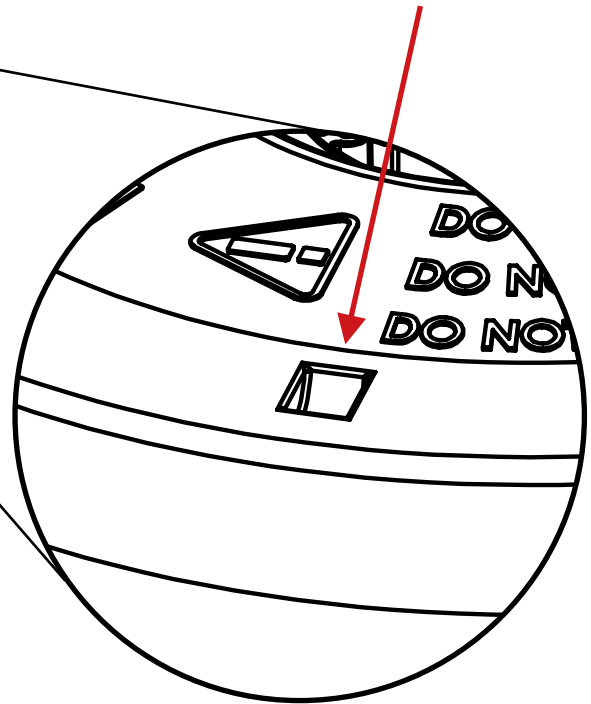

The suction screen protects the fountain from large debris. Debris small enough to pass through, like weeds or algae, will be safely macerated by the force of the impeller.

## 2. Mooring Lines & Plugs

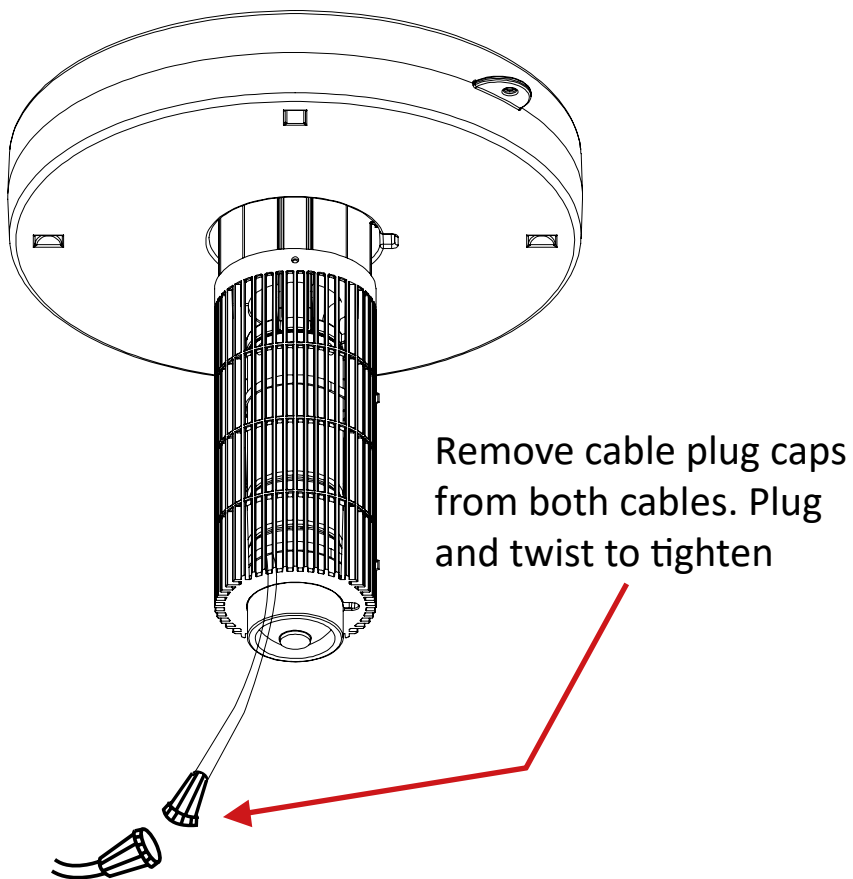
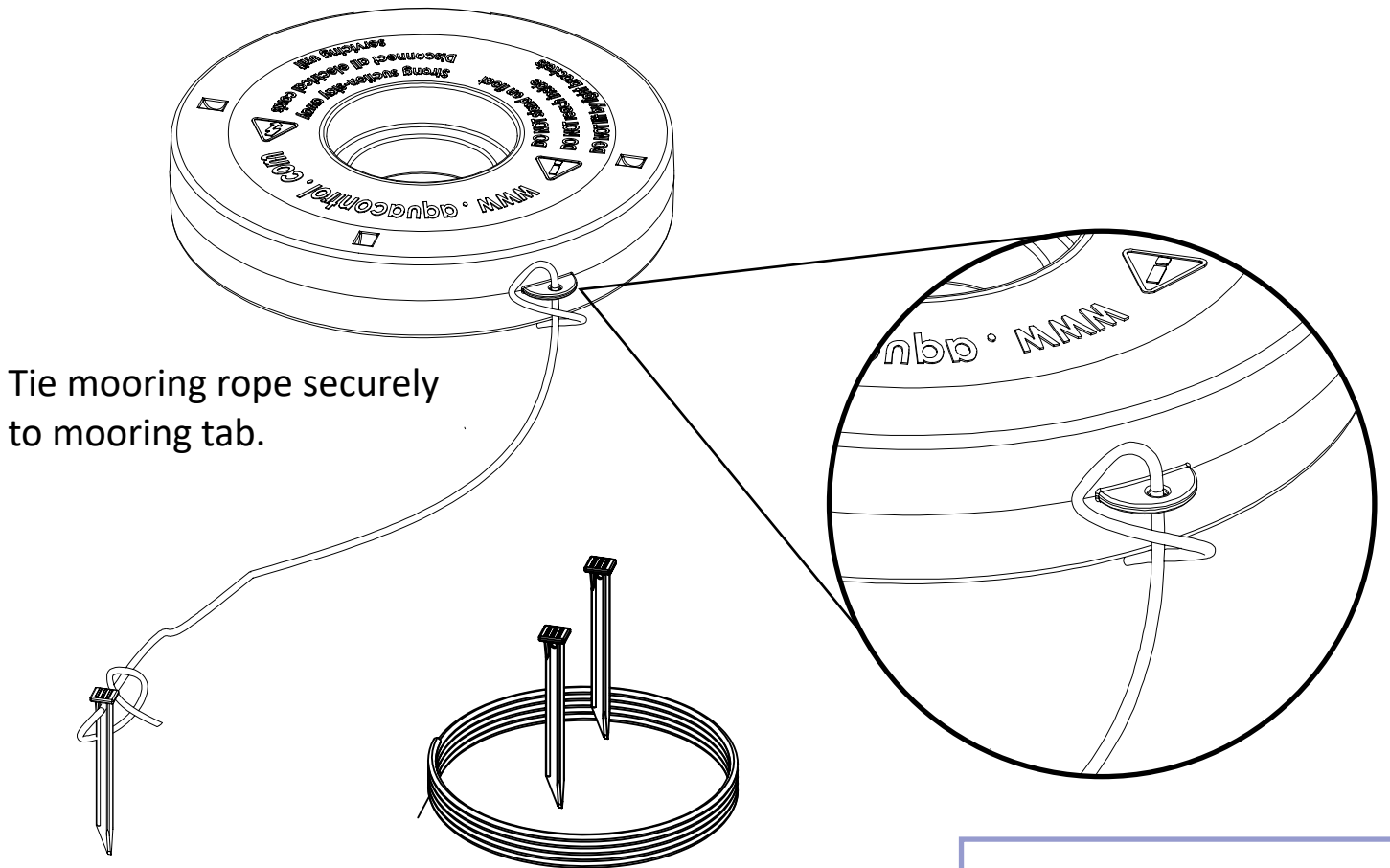

# 3. Light Installation

## Optional Light Set Installation

### Step #1

Place bracket in upper bracket slot.  
Light fixture not shown.

### Step #2

Push bracket down and snap into lower bracket slot (bottom of float).  
Light fixture not shown.

Repeat for all four lights.

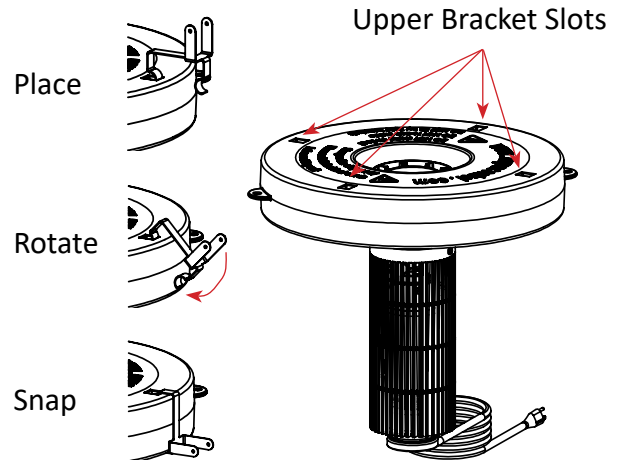

## Converting to a Torrent Pattern

### Step #1

Disconnect the unit from power

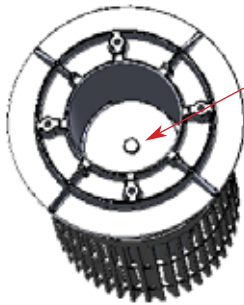

### Step #2

Remove prop washer, prop bolt and lock washer

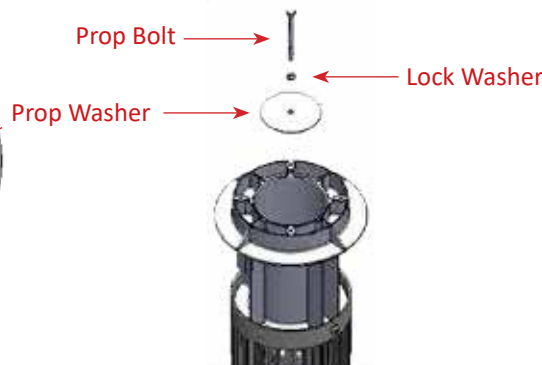

### Step #3

Reinstall prop bolt and lock washer without prop washer and tighten.

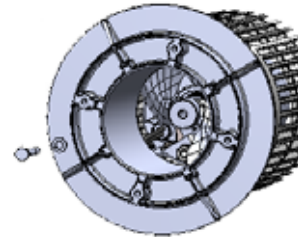

**! The aeration capability of the fountain is the same regardless of the pattern !**

### Tornado



Leave prop washer on for a Tornado display

### Torrent



Remove prop washer for a Surface Bubbler

# 4. Evolution Parts List

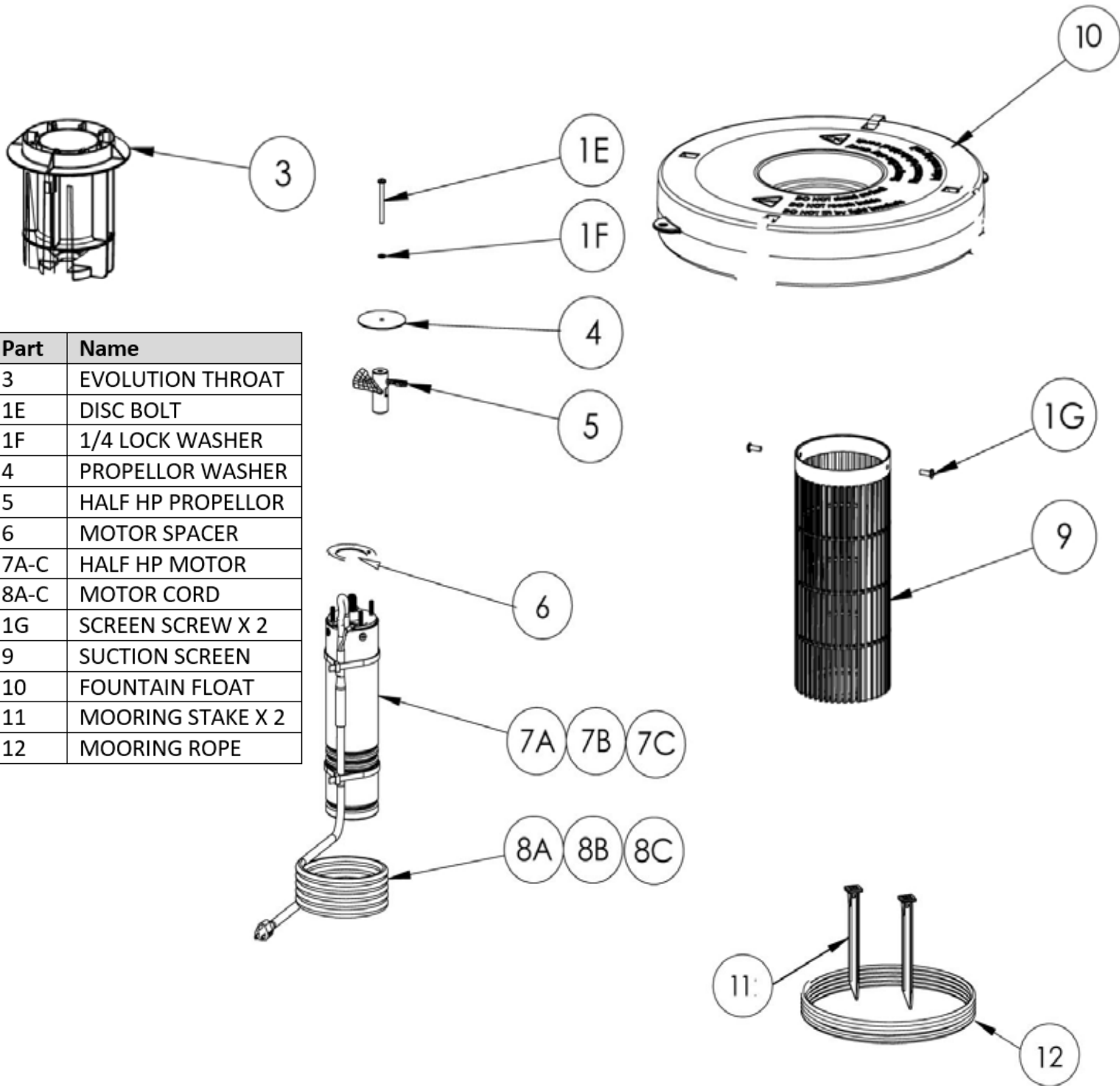

Part	Name
3	EVOLUTION THROAT
1E	DISC BOLT
1F	1/4 LOCK WASHER
4	PROPELLOR WASHER
5	HALF HP PROPELLOR
6	MOTOR SPACER
7A-C	HALF HP MOTOR
8A-C	MOTOR CORD
1G	SCREEN SCREW X 2
9	SUCTION SCREEN
10	FOUNTAIN FLOAT
11	MOORING STAKE X 2
12	MOORING ROPE

# 5. Choosing an ideal fountain location

Choose a location in your waterbody that is close to the centre and deepest spot if possible

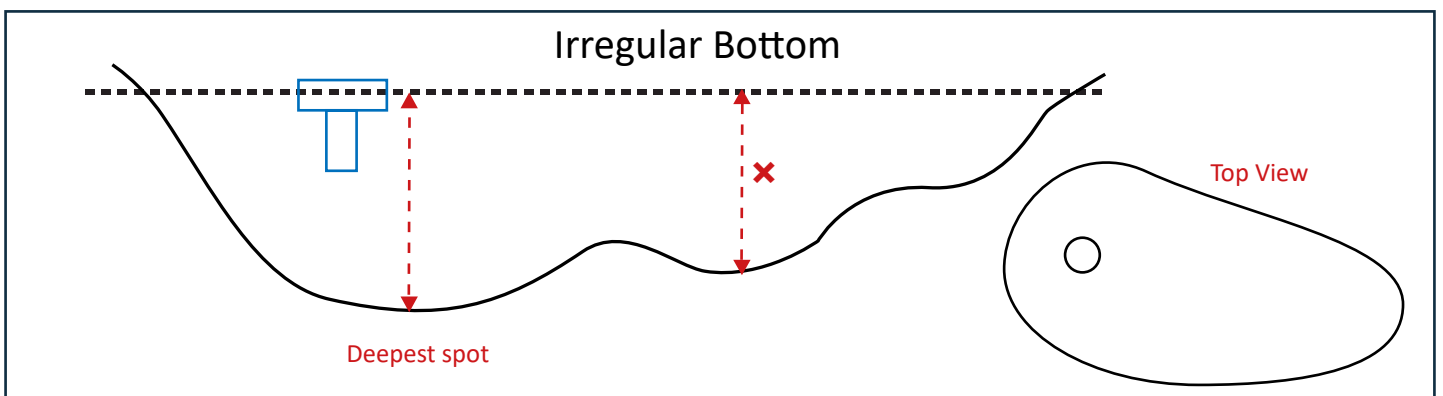
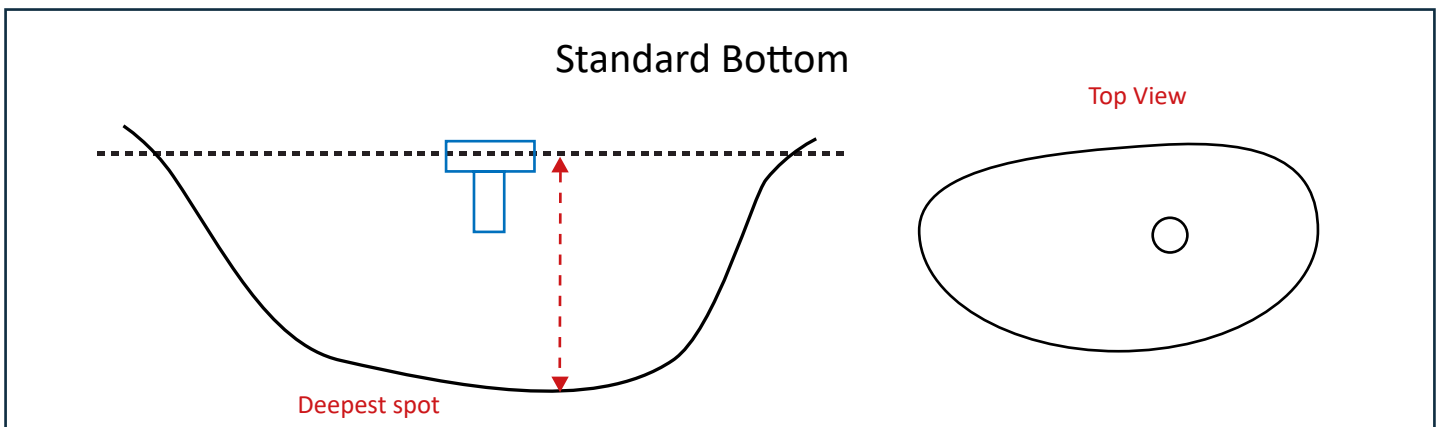
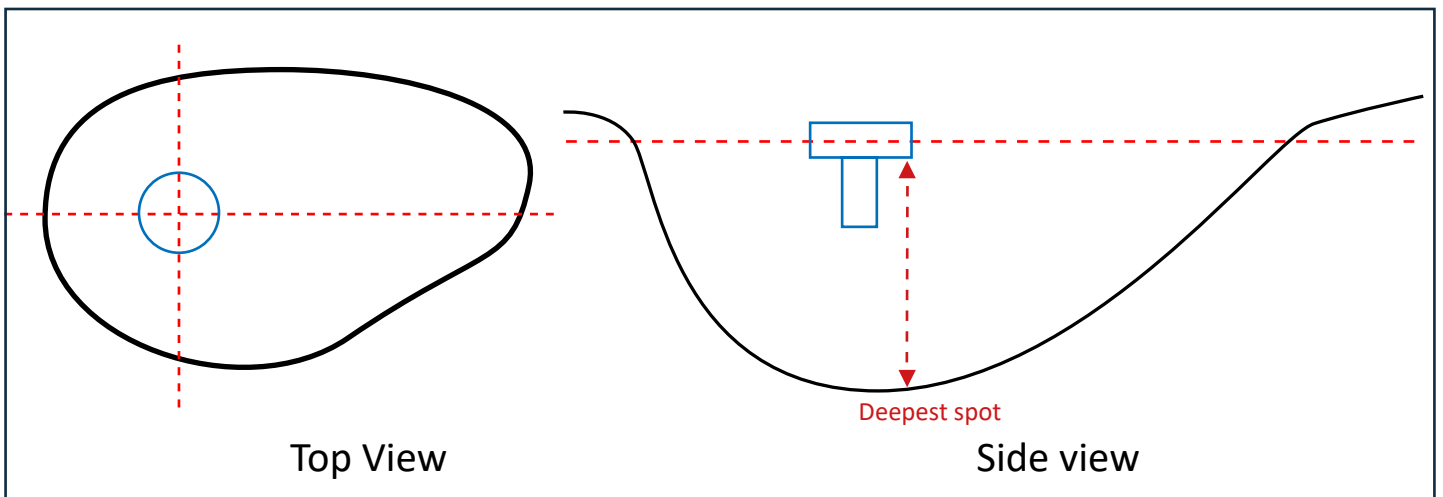
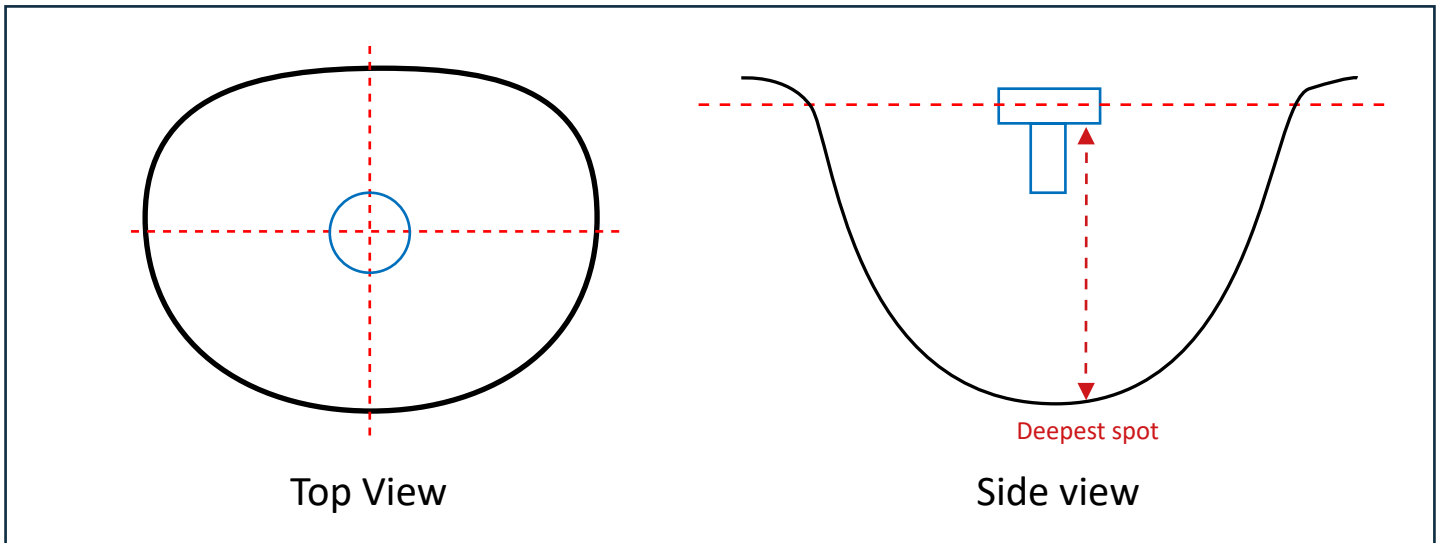



# 6. Proper Cable Positioning

1. Place fountain in waterbody and pull to desired location using the mooring lines

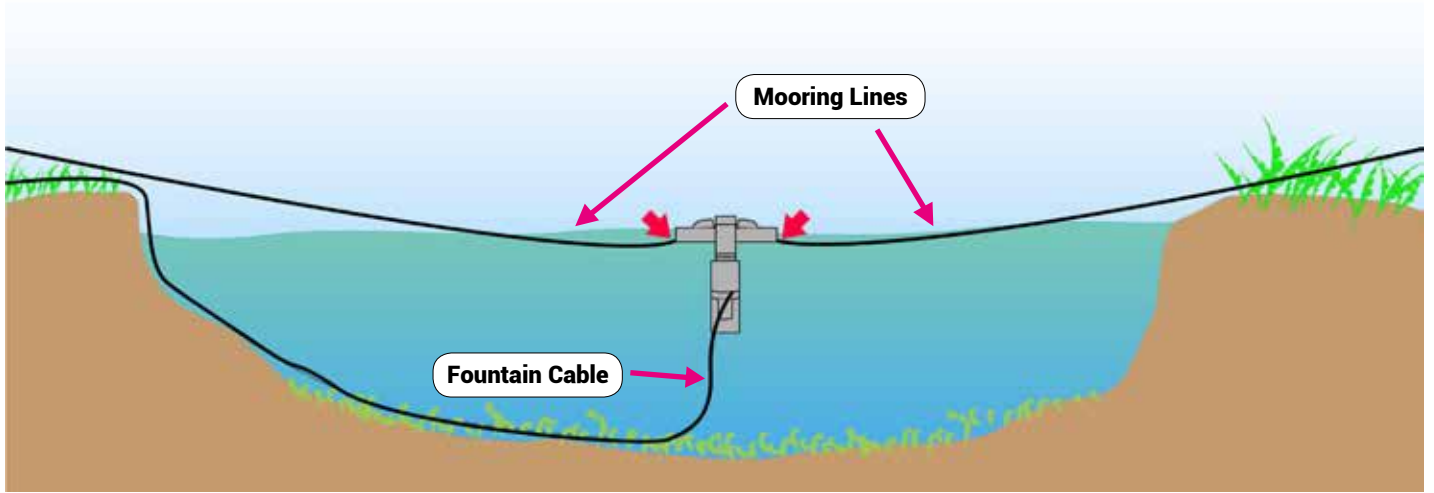

2. Pull the unit past its final location by a distance at least equal to the depth of the dam at the desired final location.

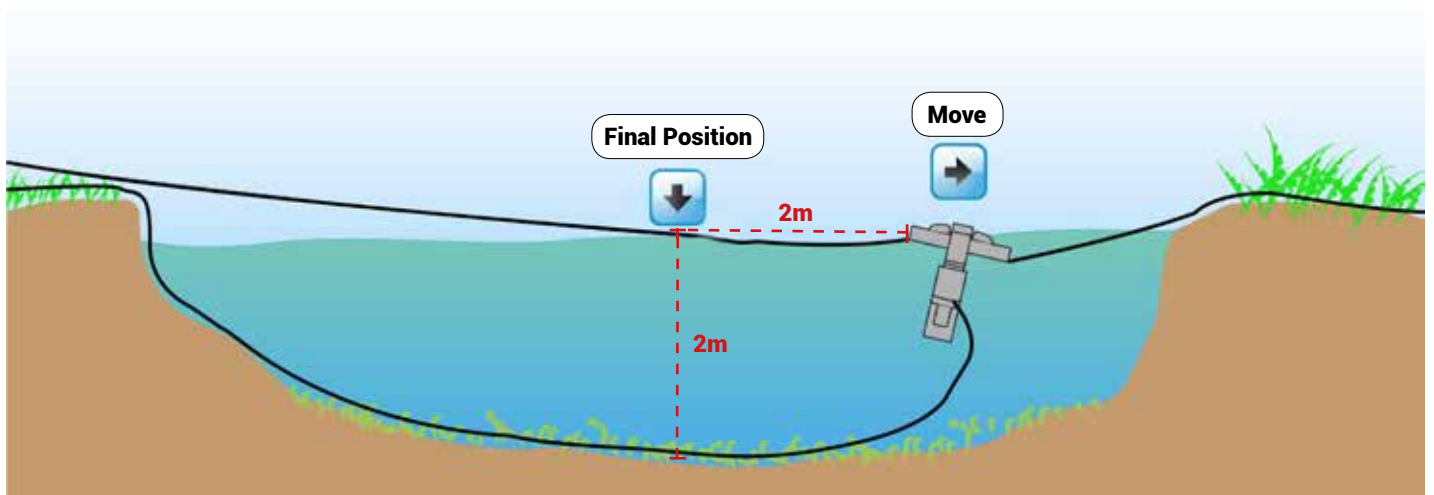

3. Bring the unit back to the final position. There should be enough slack on the electric cable to allow it to hang down without tension on the unit causing it to tilt the spray pattern. Drive in mooring stakes to secure mooring lines

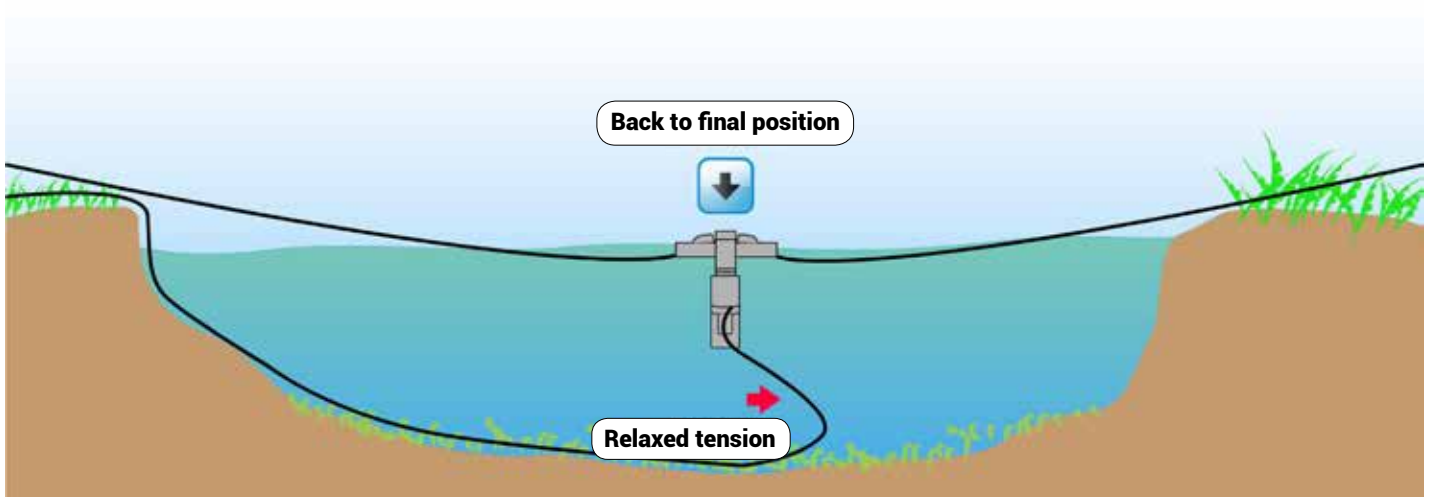

4. Hold the position of the unit in the water by tying the mooring lines securely to the mooring stakes.

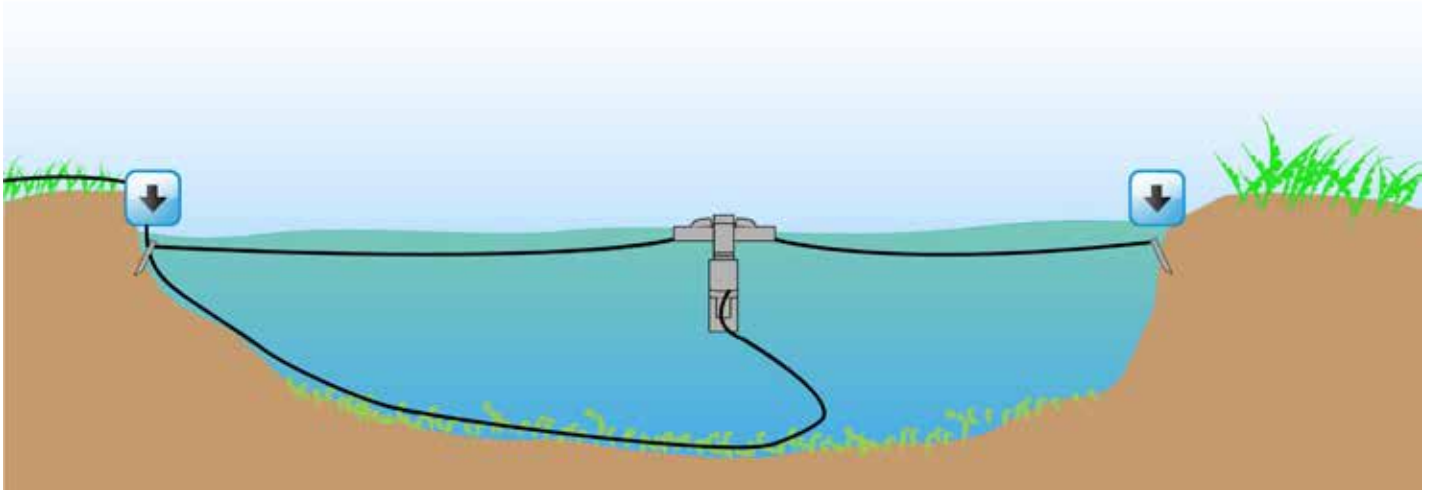

5. Motor torque causes the unit to try to rotate if the mooring lines are not tight. Upon start-up, watch to make sure the unit cannot rotate more than 1/3 of a turn. If it is allowed to rotate, the electric cable can pull around the unit very tightly and cause damage.

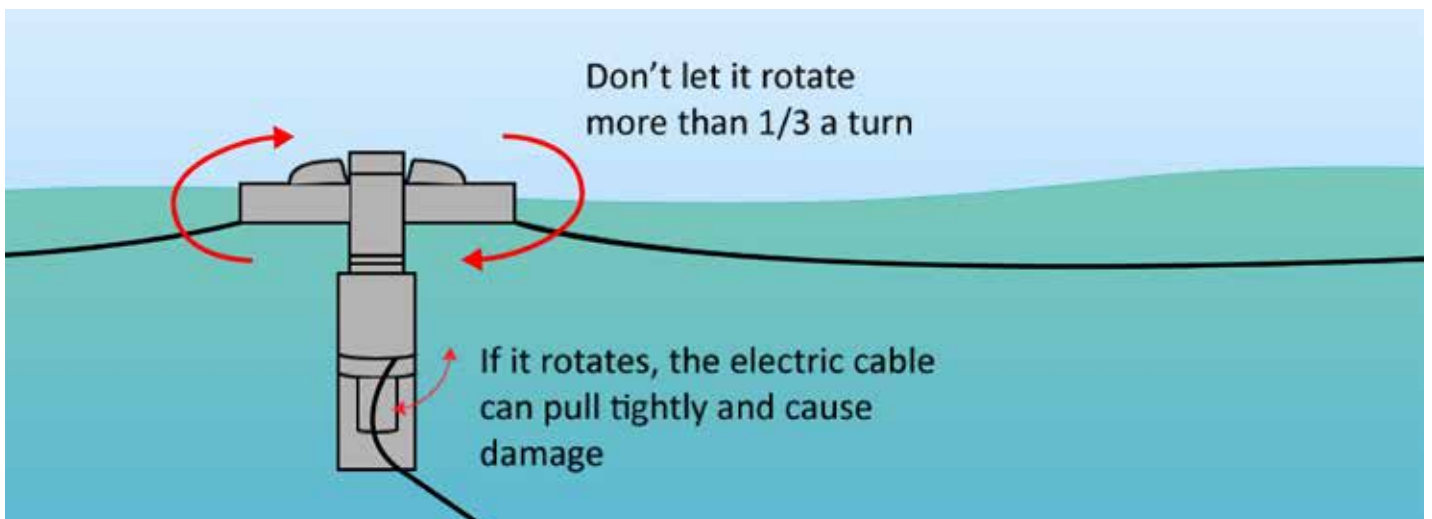

6. Never allow long lengths of rope to float near the intake of the unit where it can be pulled in and entangled in the propeller or impeller.

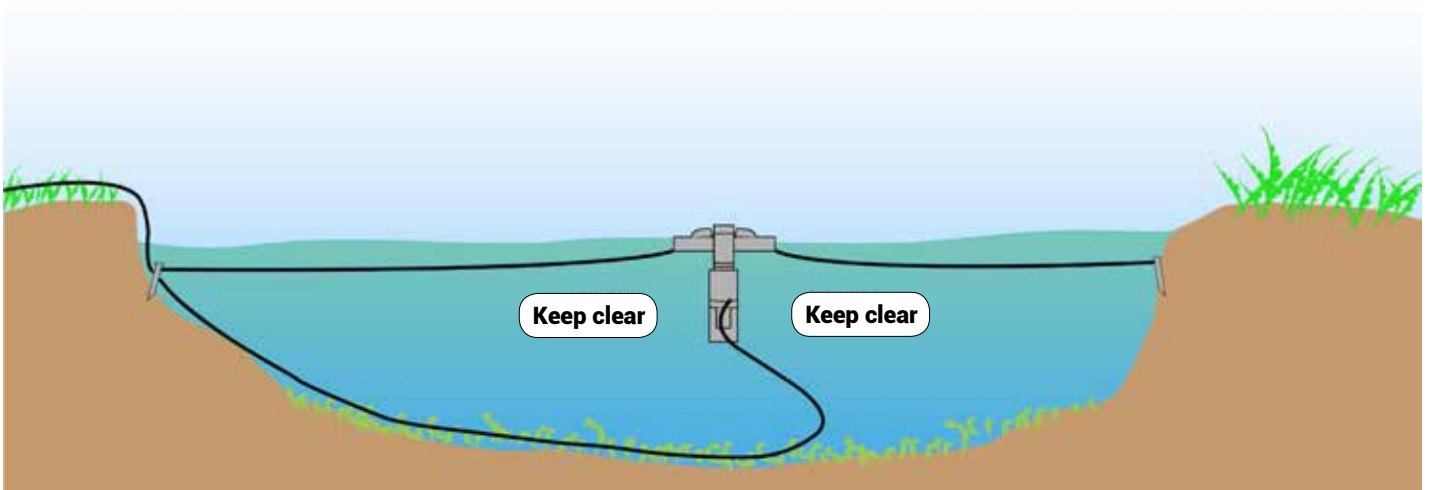

# 7. To Avoid Fountain From Tipping

A sudden change in water level can tighten the anchor line on one side, pulling the fountain and causing it to tilt. Similarly, the power cord might be tight after a water level increase. To fix this, readjust the mooring line. If the power cable is tight, undo the mooring lines, pull the fountain a few meters away from its original position, and then return it to the original position to create some slack. Remember not to power on the fountain while it's unsecured, as it will spin and cause issues. If you need to test the fountain before anchoring it, moor it to the bank or have two people hold the mooring lines before powering it on.

## 1. Mooring line too tight:

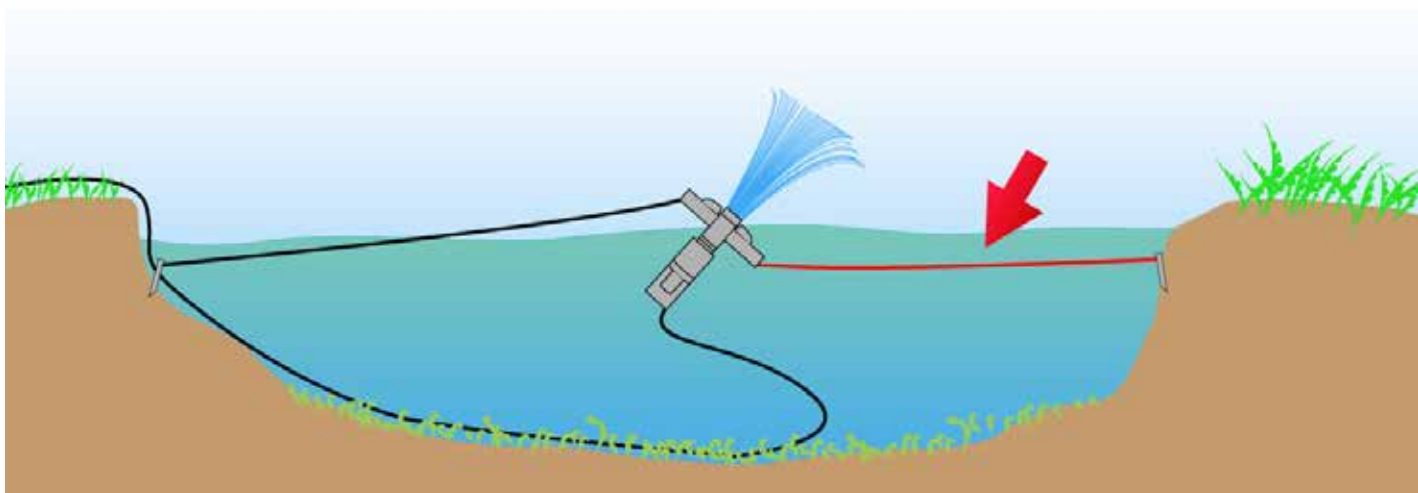

## 2. Power cable too tight:

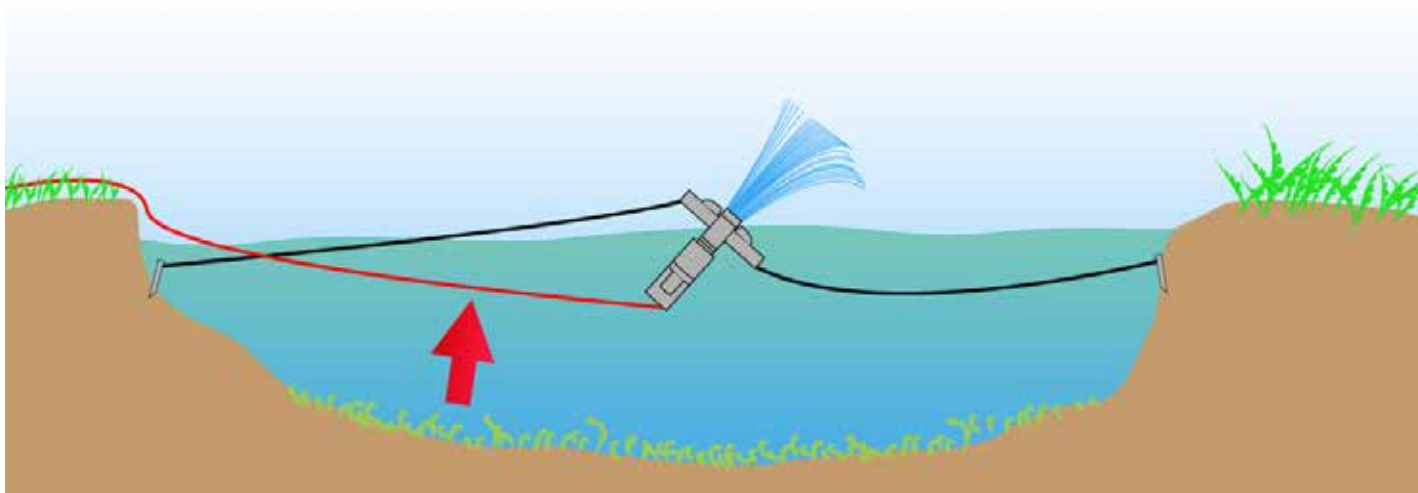

3. Anchor line too tight (if anchored to the bottom):

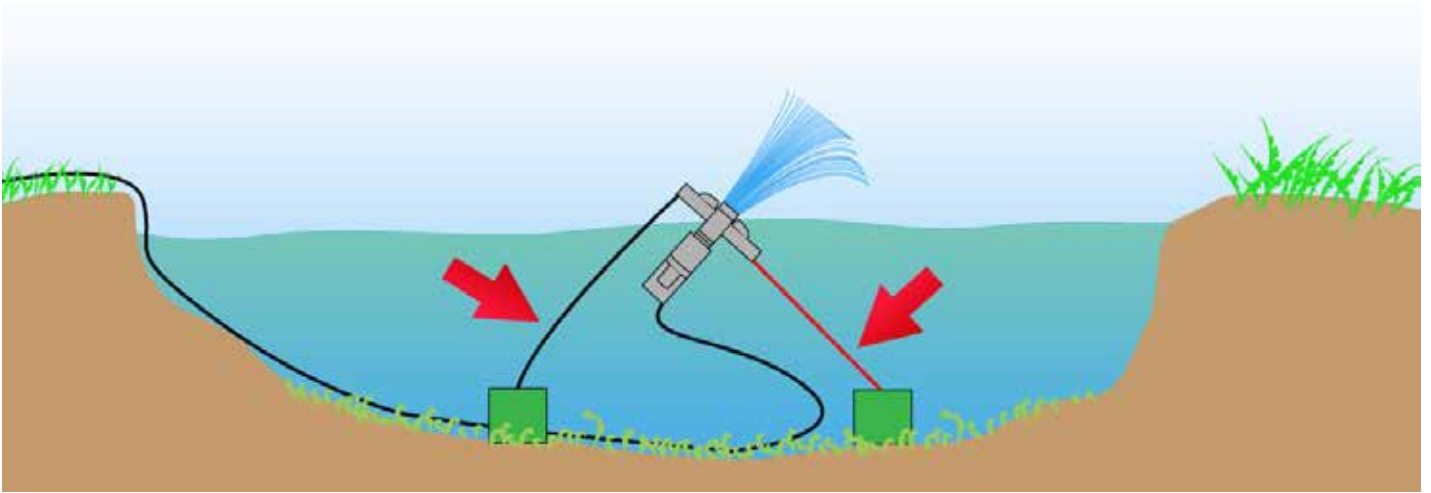

4. Water in the float: A crack or leak in the float can cause it to take on water and tilt to one side. Inspect the float for any damage where water could be leaking in.

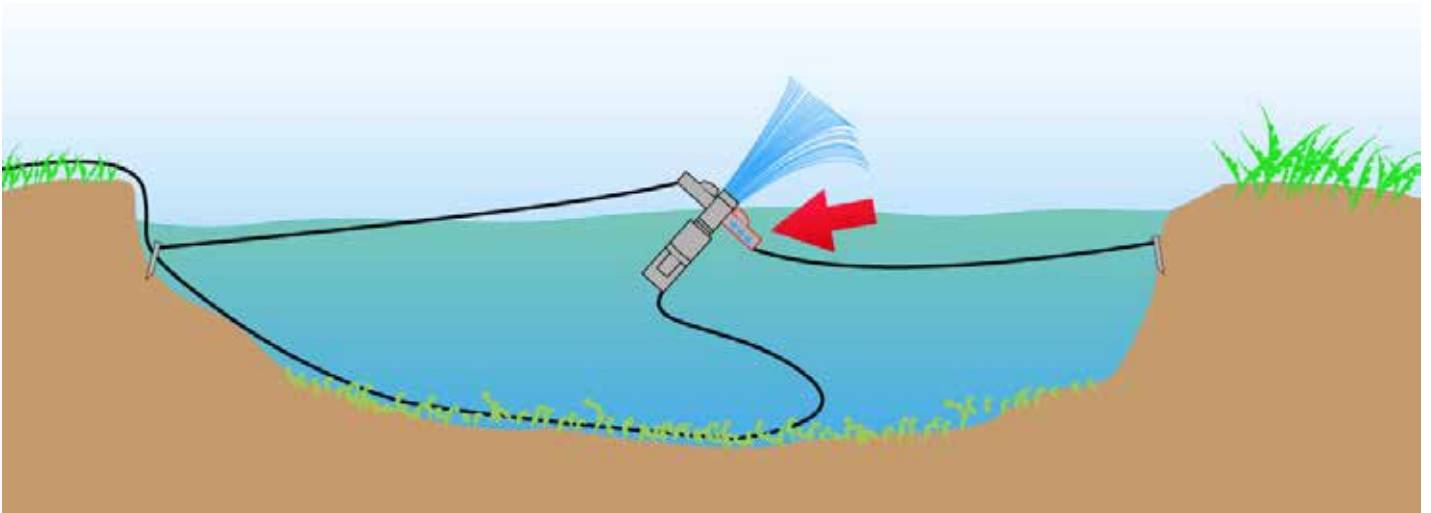

5. Possible blockage in the nozzle tips: If water is spurting out with higher or lower pressure on one side due to a blockage or damage to the nozzle, it can cause the fountain to tip. Please check the nozzle tips to ensure they are clear and undamaged.

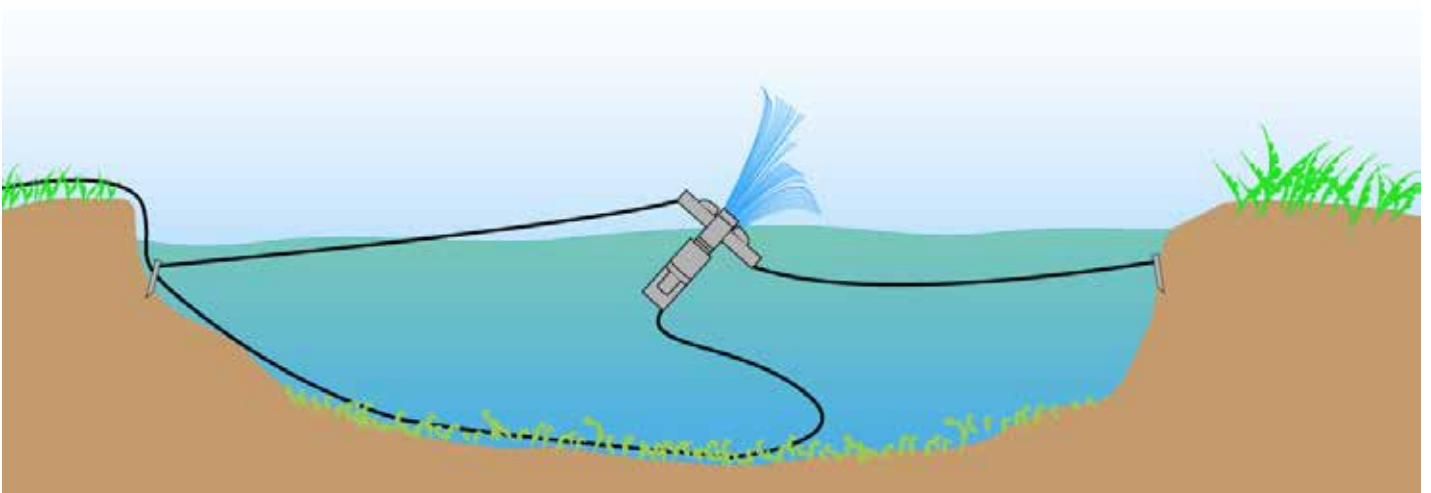

# 8. How to Stake

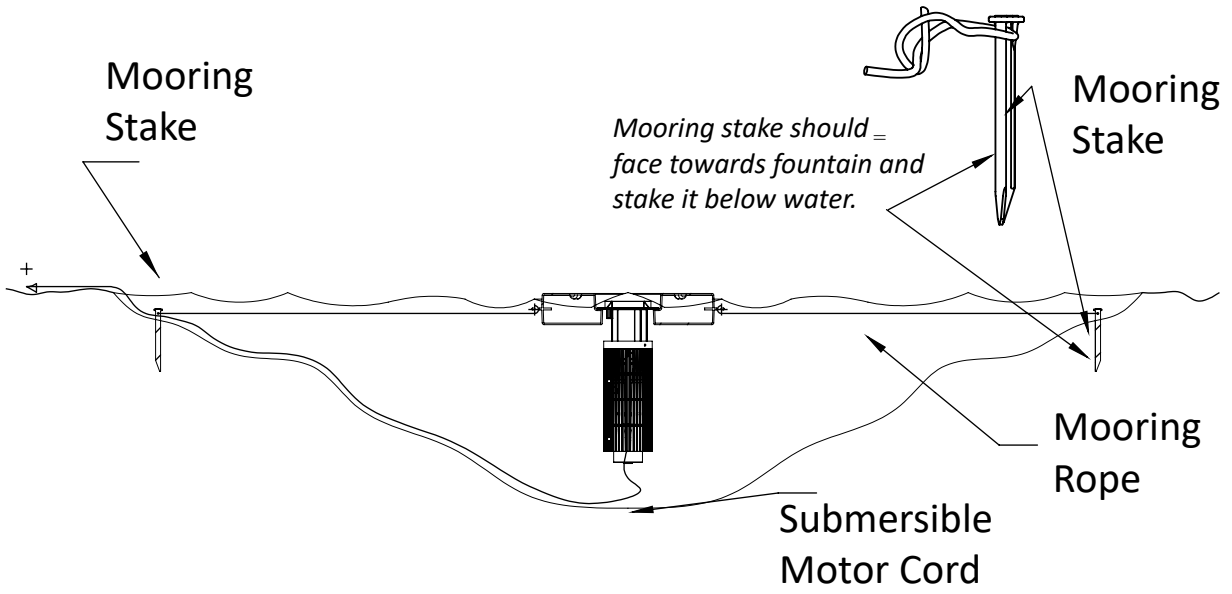

# EVOLUTION HALF HP SERIES FOUNTAIN TROUBLESHOOTING GUIDE

Trouble	Check	Possible Solutions
Fountain does not work or starts and stops	<p>Not plugged in</p> <p>RCD tripped</p> <p>RCD not tripped, not running</p>	<p>Cord must be plugged into a 3-wire outlet that is protected by a Residual Current Device (RCD).</p> <p>Reset RCD. If the RCD will not reset or trips immediately, unplug pump and lights and reset RCD. If the RCD will not reset, there may be a problem with the motor or the incoming power. If the RCD resets, plug the pump in. If the RCD trips, there may be a problem with the pump cord. If the RCD holds, plug into the optional lights. If the RCD trips, there may be a problem with the lights. Contact Technical Support to troubleshoot lights or pump.</p> <p>Disconnect power. Check propeller for obstruction. These motors have internal overloads. If the propeller is jammed, the internal overload may trip. This overload may require up to 10 minutes to cool down and reset. If the motor does not restart, there may be other motor problems. Contact Technical Support to troubleshoot the pump.</p>
Fountain spray pattern is smaller	<p>Fountain intake clogged</p> <p>Nozzle clogged</p>	<p>Disconnect power, check suction screen for obstruction and remove debris.</p> <p>Disconnect power, remove nozzle and check for obstruction and remove debris.</p>



**Head Office:** 41 Yazaki Way, Carrum Downs, Vic. Australia 3201 | **Phone:** 03 9071 2442

For more information visit [www.FOUNTAINSAUSTRALIA.com.au](http://www.FOUNTAINSAUSTRALIA.com.au)